

IPTG □ SERIES

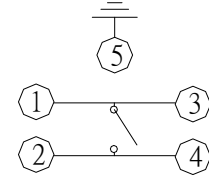

DIMENSIONS

IPTG14

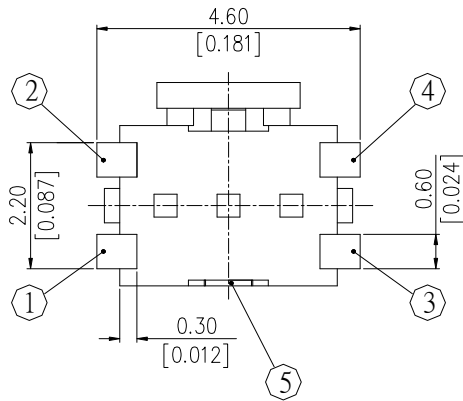
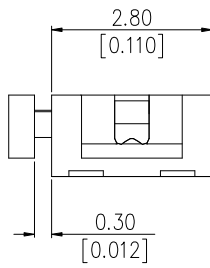
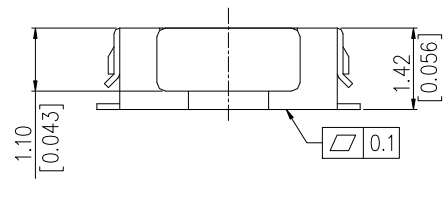
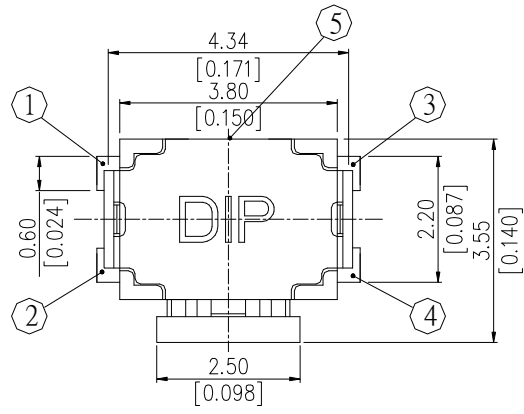

CIRCUIT DIAGRAM

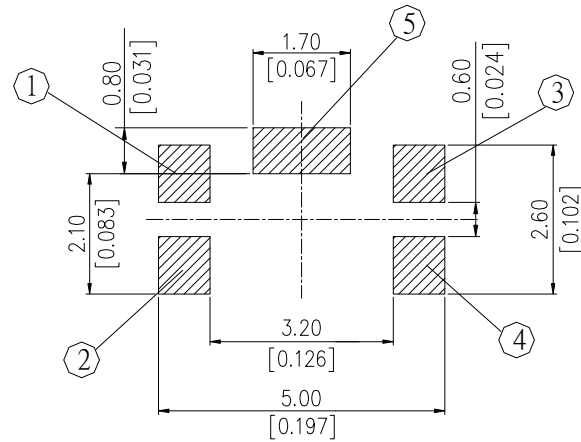

P.C.B. LAYOUT

General Tolerance : ±0.2mm

IPTG23

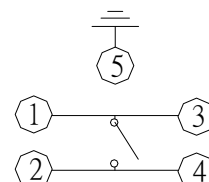
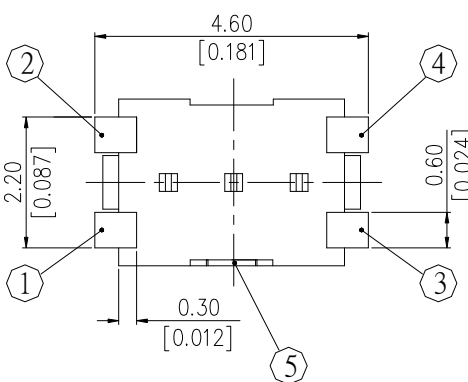
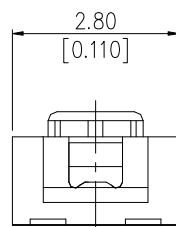
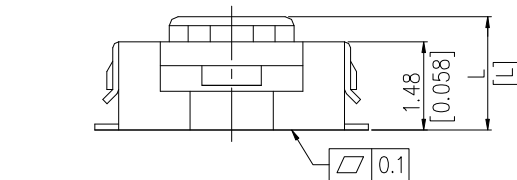
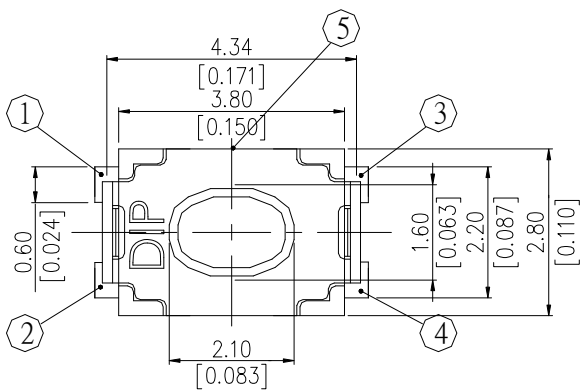

CIRCUIT DIAGRAM

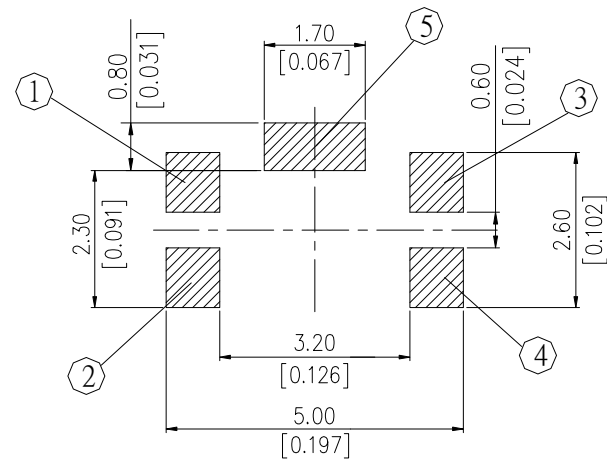

P.C.B. LAYOUT

IPTG3	2.50[.098]
IPTG2	1.90[.075]
PART NO.	L

General Tolerance : ±0.2mm

HOW TO ORDER

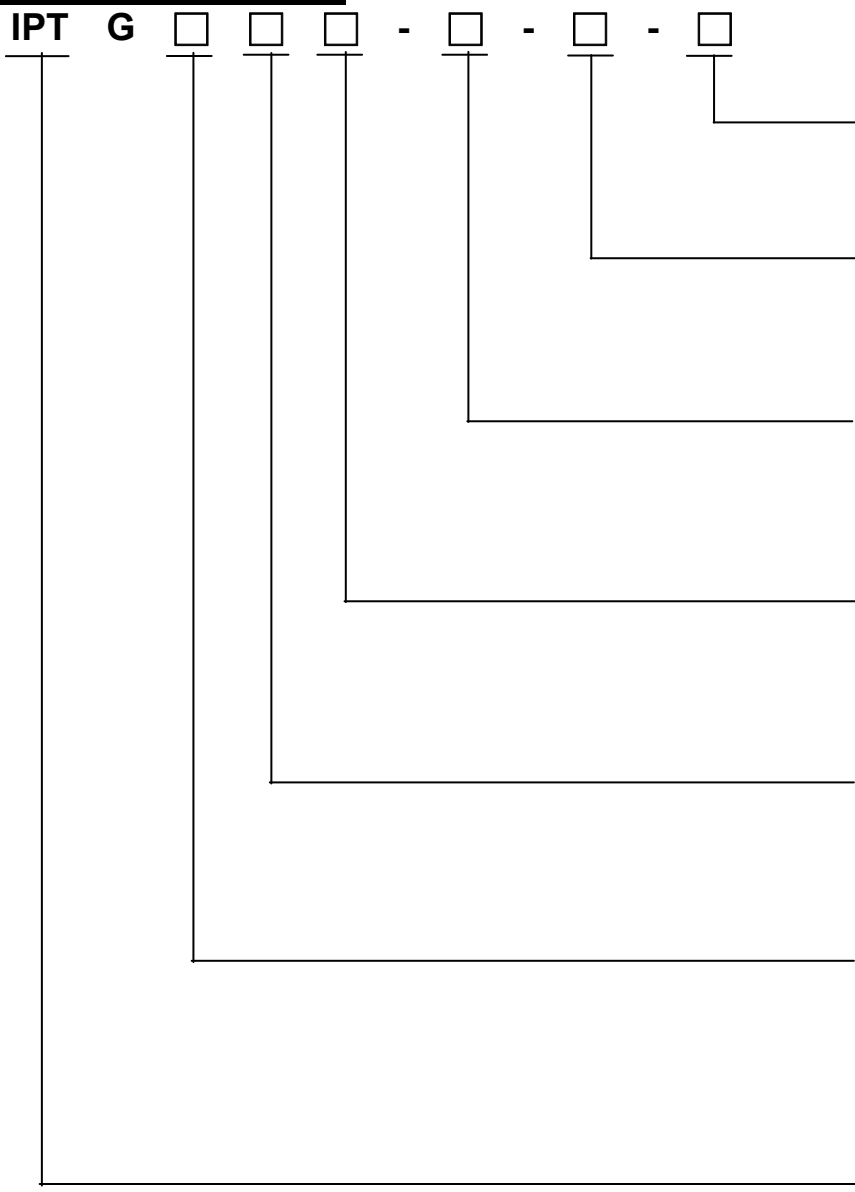

Package Style :
T/R=Type & Reel

Soldering :
V=RoHS & Lead Free Solderable
Q=Halogen Free

Contact Material
□=Silver
A =Gold

Actuator Color :
K=Black
W=White

Operating Force :
3=160gf(Only for Vertical Push)
4=200gf(Only for Side Push)

Height for Vertical Push:
1=Side Push
2=Vertical Push H : 1.9mm
3=Vertical Push H : 2.5mm

Tiny Slide/Vertical Slide

SPECIFICATION

△MECHANICAL

Operation Force: 200 ±65gf (Side Push)
160 ± 50gf (Vertical Push)

Stroke: 0.20±0.1mm (Side Push)
0.13±0.1mm (Vertical Push)

Operation Temperature: -30°C to +80°C

Storage Temperature: -40°C to +85°C

△ELECTRICAL

Electrical Life: 50,000 cycles

Rating:50mA , 12VDC

Contact Resistance: 100mΩ max.

Insulation Resistance: 100MΩ min. at 100VDC

Dielectric Strength: 100VAC/1 minute

MATERIAL

△COVER: Stainless steel with silver plating

△SPACING COVER : Stainless steel

△STEM: UL 94V-0 High-temp thermoplastic
Color: Black

△TAPE : Teflon

△CONTACT : Stainless steel with silver plating

△BASE : UL 94V-0 High-temp thermoplastic

Color: Black

△TERMINAL : ①Brass, with silver plating

②Brass, gold plated

SOLDERING PROCESS

△HAND SOLDERING : Use a soldering iron of 30 watts, controlled at 350°C approximately max 5 seconds while applying.

△REFLOW SOLDERING: When applying reflow soldering, the peak temperature or the reflow oven should be set to 260°C max.

△Reflow Temperature Profile:

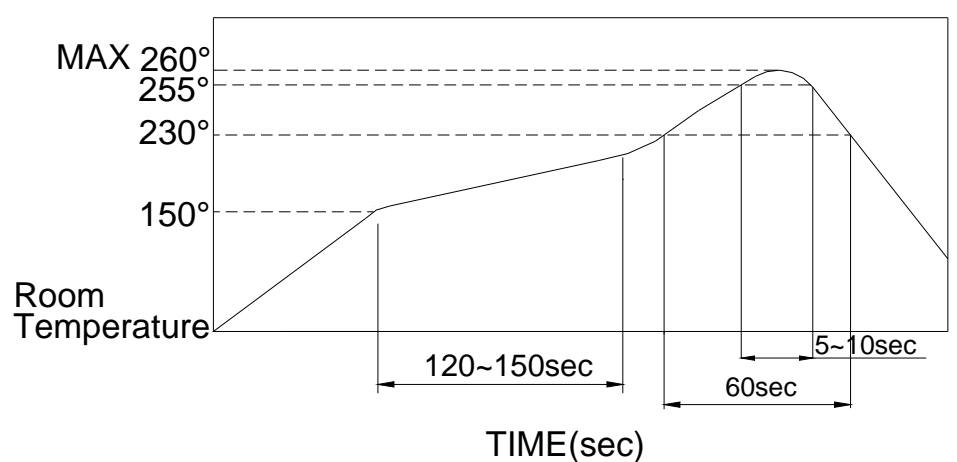

PACKING

Part Number	Number Per Reel	
IPTG14	3500	
IPTG23	7000	
IPTG33	6300	

IPTG14 REEL

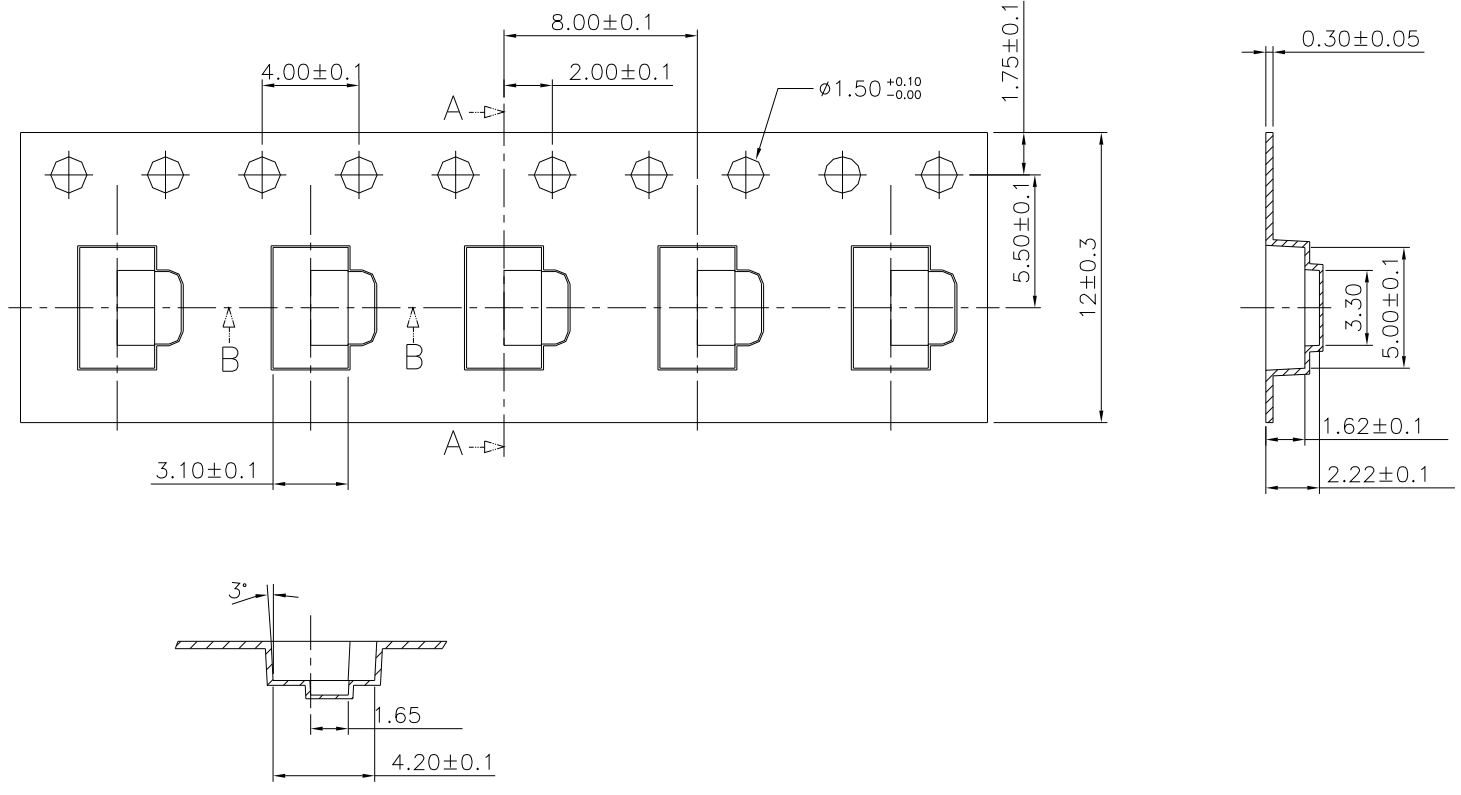

General Tolerance : ±0.1mm

IPTG□ REEL

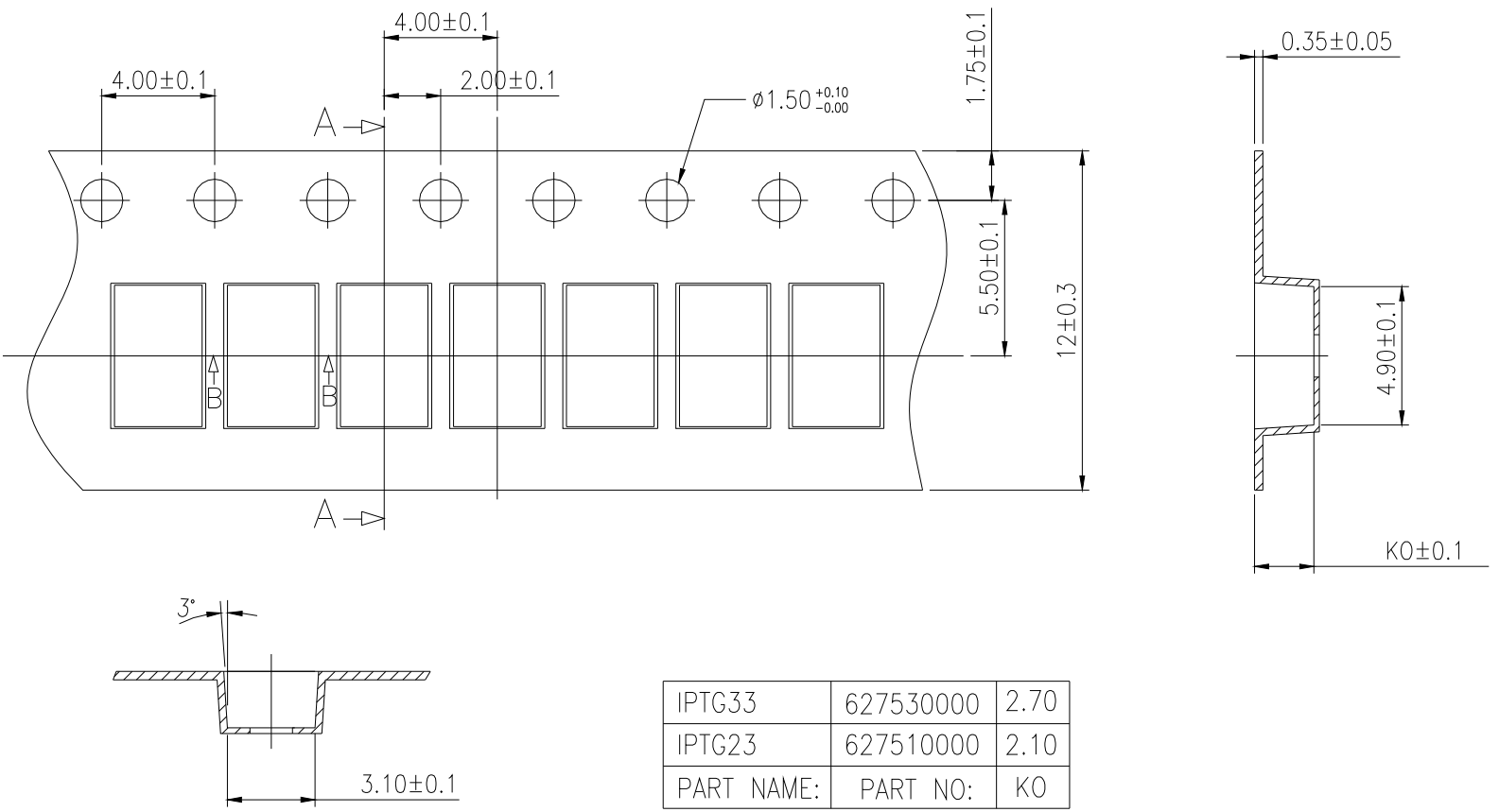

IPTG33	627530000	2.70
IPTG23	627510000	2.10
PART NAME:	PART NO:	K0

General Tolerance : ±0.1mm